

ToddPod™

The Ultimate Outdoor Shower Enclosure

Installation Manual

This Manual can be used for all Models

Contact us at 888-545-9763 or email us at
office@toddpod.com with any questions during installation.

Our service team is available 24/7.

OSDC

2616 E. State Street
Hamilton, NJ 08619

ToddPod™

The Ultimate Outdoor Shower Enclosure Installation Manual

Floor Model Options

Single Models Size 46" d x 46" w x 88" h

Model STP-1

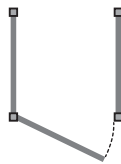

Model STP-2

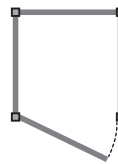

Double Models Size 46" d x 88" w x 88" h

Model DTP-1

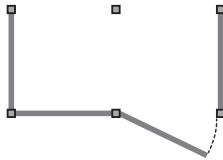

Model DTP-2

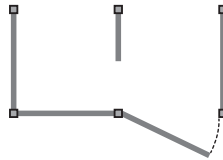

Model DTP-3

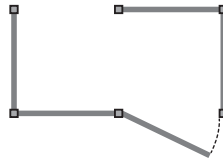

Model DTP-4

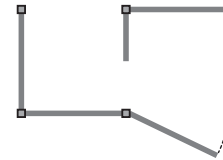

Model DTP-5

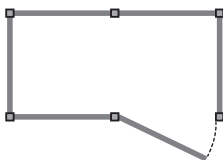

Model DTP-6

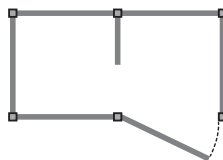

Model DTP-7

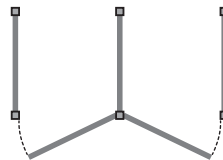

Model DTP-8

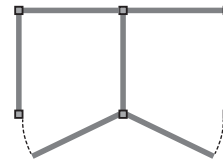

Tools Required:

Tape Measure, Screw Gun, Level, Pencil, 7/16" Socket Wrench and Silicone.

All hardware for shower parts are included in part box. #2 Square tip bit is included in door hardware box.

You will need the necessary screws/bolts needed to mount unit to the ground. If placing shower on pavers, cement or blacktop; you will need 2 ½" X ¼" Tapcon screws, washers and a ¼" masonry drill bit (6 screws for a double unit and 4 screws for a single unit)

If placing your shower on gravel, grass or dirt, we recommend that you use a 6 x 6 pressure treated wooden base.

6 X 6 Base:

****6 x 6 frames shall be no greater than dimension of unit****

Double Unit 6x6 Base:

- 10 qty. - 5" x 3/8" Galvanized lag bolts
- 2 qty. - 46" Pressure Treated Wood
- 2 qty. - 88" Pressure Treated Wood

Single Unit 6x6 Base:

- 8 qty. - 5" x 3/8" Galvanized lag bolts

1. Create a lap joint at 5 1/2" in length and 2 3/4" in depth on both ends of each piece of wood.
2. Overlap each cut out connection and fasten with (2) 5" x 3/8" lag bolts.
3. Flip the frame over to ensure a smooth surface for the aluminum frame installation.
4. Dig the wood sub-frame into the ground and make sure it is level and stable around the perimeter. Fill the interior with 3/8" stone for a French drain



1) Setting Frame and Posts:

- a. Remove base frame from the single base frame box and lay on surface where the shower unit will be installed. It is important that the base frame is level prior to going any further with the shower installation. If installing a double unit, align the expander base frame with the single base frame and fasten using 3/4" self tapping screws. (See PIC 1a)***It is important to determine your door location, door swing, and all wall locations before unit installation begins.*** See Floor Plan provided with installation manual.

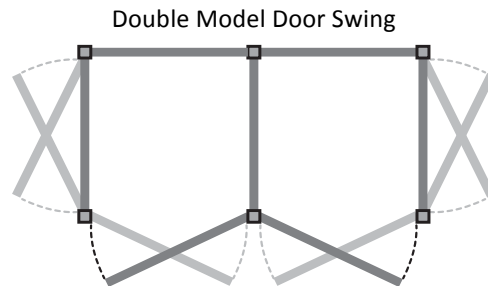
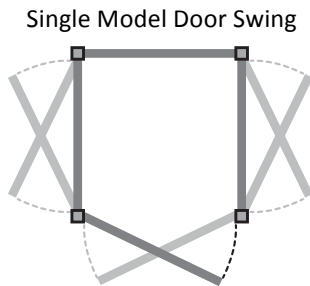

- b. Remove one set of posts from the post box and place on the base frame where you would like your wall panel to go. The post flange will already be attached to the post. Lift flange to access where post bolts secure to base frame without removing flange from post.
- c. Finger Tighten the posts to the base frame using $7/16"$ x $3/4"$ stainless steel bolts (4 per post). ***Do NOT over tighten!** Allow room to move the post slightly this is important to be able to set the wall panels. (See PIC 1c)

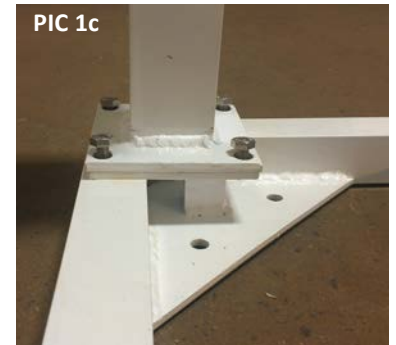
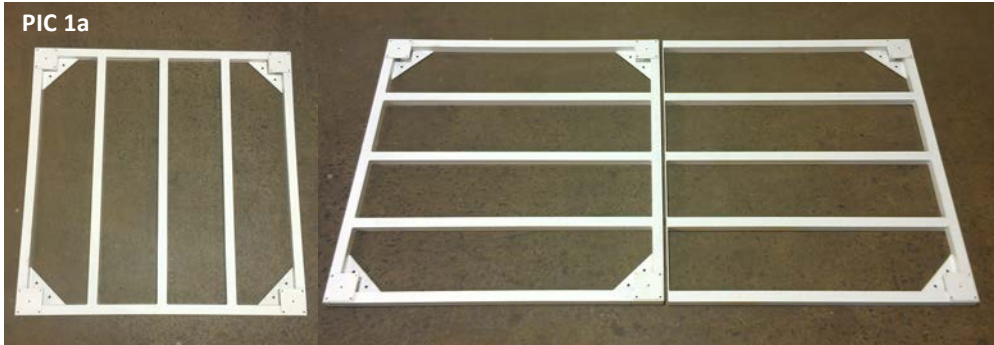

2) Installing Wall Panels and Post Bracket:

- a. On the side of the post where the post bracket will sit measure down 1" from the top of the post and measure 1" over from side of the post forming a T and mark with a pencil. (See PIC 2a)
Important This will keep header and top of the wall panel aligned.
- b. Align the top of the post bracket with the top of the "T" and center the post bracket screw hole with the center of the "T". Attach the bracket using the self tapping $3/4"$ stainless steel screw (provided in wall panel box). (See PIC 2b)
- c. Measure down from the top of the post bracket 72 1/2" and mark a pencil line. Above that line measure over 1" from the side of the post forming an upside down "T". (See PIC 2c)
- d. Align the bottom of the post bracket with the bottom line of the upside down "T" and center the post bracket screw hole with the center of the upside down "T". Attach the bracket using the self tapping $3/4"$ stainless steel screw (provided in wall panel box). (See PIC 2d)
- e. Repeat steps 2a thru 2d on adjacent post where wall panel will be installed.

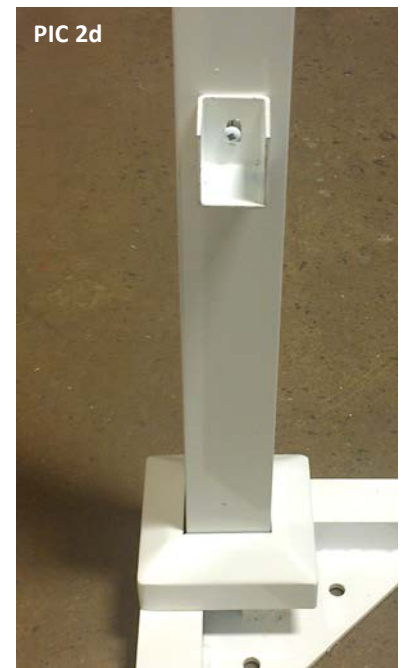
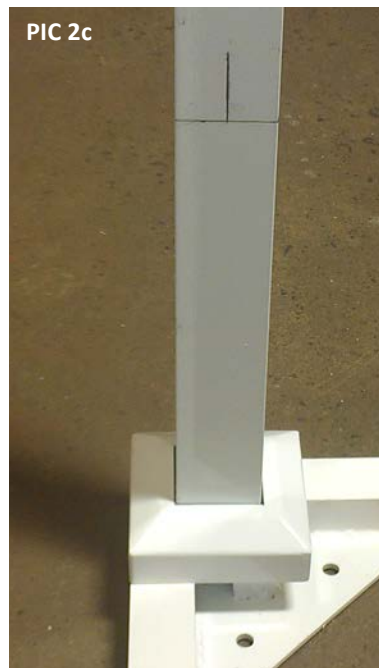

- f. Set the wall panel into the bottom brackets first, and then pull the posts away at the top. The top of the wall panel should clear the top wall bracket and fit snug. If the wall panel does not clear the top panel bracket and fit snug loosen the post bolts. (See PIC 2f)
- g. Fasten the wall panel to the brackets using the self tapping $\frac{3}{4}$ " stainless steel screws on all four corners of the wall panel. ***All screws must be facing the interior of the shower & centered on bracket.** (See PIC 2g)
- h. Continue this process until all wall panels are installed. If there is any part of the shower facing an existing structure and a wall panel is not being installed a header will be provided in order for you to secure the two posts. This header will also need to be installed on the top of the door. Follow steps 2a and 2b to attach the brackets, and then attach the header (open side up) to the brackets using self tapping $\frac{3}{4}$ " stainless steel screws. (See PIC 2h)
- i. Tighten the bottom bolts of each post to secure the unit. The post must be tightened evenly to ensure unit will be level.



3) Installing Half Wall Panel (Double Units):

- a. Only 3 post brackets are required for the half wall. 2 for the half wall header and 1 for the bottom of the half wall. Refer to steps 2a thru 2d for post bracket installation.
- b. Install the half wall panel into the header so that the end of the header is flush with the end of half wall so that the tab is facing toward the center of the header.
- c. Fasten a self tapping screw through the top of the header into the tab of the half wall to secure the frame to the header. The screw should go 14 $\frac{1}{2}$ " in from the end of the header that's flush with end of the half wall. Then install the half wall and header into the wall brackets using the self tapping screws. (See PIC 3c)



4) Secure Shower Unit to Surface

- a. If you are placing your shower on pavers, cement or blacktop; attach the frame to a level surface using 2 $1\frac{1}{2}$ " x $\frac{1}{4}$ " Tapcon screws (6 screws for a double unit and 4 screws for a single unit). Plastic shims are recommended to avoid contact.
- b. Before screwing down the frame, use galvanized washers or shims to level frame. ***The frame must be level prior to fastening***.
If placing your shower on a wooden surface attach the frame using 4" x $\frac{3}{8}$ " lag bolts (6 qty. for double unit and 4 qty. for a single unit). ***The frame must be level prior to fastening***.

5) **Installing the Roof:**

2 people are recommended for this step.

- a. Assemble the roof on the ground by sliding the louvers through the cross beams. (See PIC 5a)



- b. For privacy purposes determine the direction you would like your louvers to go. If you are using the pergola end caps it is important to use silicone to secure them to the cross beams in the front of the shower (door side). (See PIC 5b-1) Secure the end caps with silicone to the back side of the cross beams. (See PIC 5b-2)



- c. Space cross beams approx. 9 3/4" apart. With one person standing inside the shower to guide and support the roof, lift the roof and slide it into place. Make sure the back of the cross beams are flush with the shower unit before proceeding. The end cross beams should sit just inside your top wall brackets. Check measurement on cross beams to ensure they are still at approx. 9 3/4" apart. (See PIC 5c)



- d. Use the L brackets and self tapping 3/8" stainless steel screws to attach each cross beam to the inside of a wall panel or header on both the front and rear of the shower. (See PIC 5d)



- e. It is time to secure the peek a boo bracket on either side of the roof. Place the pre-drilled holes against cross beams. Center it to where it should be (approximately 5" on either side). Use self tapping 3/8" stainless steel screws in the pre-drilled holes to secure the peek a boo bracket to the louvered roof. (See PIC 5e)



6) Installing Shower Door:

Make sure the unit is secured to the surface and level so the door sits plumb. Determine your door swing prior to moving on. All screws for the door are included in the door hardware box.

- a. Follow steps from 2a & 2b to ensure the header bracket is installed prior to door installation.
- b. Measure in 7/8" from outside of post and draw three separate marks going down the side of the post where the door hinge will sit. Hinge pin must be on outside of post when door is closed. (See PIC 6b)

Important This will ensure the hinge is secured straight on the post.



- c. Install the door hanger on the top corner (hinge side) of the front of the door. (See PIC 6c-1) Hang the door so that the door hanger is on the top of post that the hinge will be on so that the door will be in the fully open position. (See PIC 6c-2) Door should align with the lines that were drawn in step 5b. Using the self tapping stainless steel screws, attach the hinge to the post (inside) into the pre-drilled holes. (See PIC 6c-3)

*** Must start with the bottom screw and work your way up to the top screw.***



7) Installing the Lock:

- a. Remove the lock from the door hardware box and ensure deadbolt is in the closed position. ***Important***
- b. Separate the door lock and place spacer over door lock so that the flat side of the spacer is against rubber seal while positioning the notched end of the spacer toward the dead bolt. (See PIC 7b)



- c. Insert spacer on the inside of the door (See PIC 7c-1). Attach the other half by matching the notched pin into the opening of the red lever. Secure to the door by using the four ¼" stainless steel screws provided. (See PIC 7c-2) Use the two ¼" stainless steel screws provided to secure the lock to the side of the door. (See PIC 7c-3)



- d. Hold the door in the closed position and mark the proper location to attach the strike plate. (See PIC 7d)
- e. Attach the strike plate using the self tapping ¼" stainless steel screws. Make sure edge is flush with front edge of post and the beveled edge is on the outside so the door closes properly. (See PIC 7e)
- f. Attach the door stop to the post behind the strike plate. It is important to have the center hole of door stop align with the middle of the strike plate. (See PIC 7f)



8) Installing the Towel Bar:

- a. Measure and mark 2 adjacent posts 54" from the up on the side where the towel bar will be placed.
- b. Attach the towel bar to the posts using the self tapping stainless steel screws. (See PIC 8b)



9) Installing the Floor:

- a. For a single base frame start at either edge of the frame, lay one of the pre-assembled floor panels in place; followed by the matching interlocking panel. Note the floor planks should run perpendicular to the frame joists. (See PIC 9a)
- b. For the expander frame the floor panel with the smaller plank is to go on the side away from the single base floor with the floor planks perpendicular to the frame joists. Install the remaining floor panel in the open space next to the single base floor frame.



10) Install the Post Caps:

- a. Use silicone to secure post cap to the top of each post. (See Pic 10a)

